



New Health Sciences Building

Central Carolina Community College

Chatham County, North Carolina

January 2018





AERIAL VIEW





15/501 VIEWSHED CORRIDOR-PLANTING CONCEPT | BRIAR CHAPEL - SD WEST COMMERCIAL - 09.05.2017

SITE MASTER PLAN

Newland COMMUNITIES Surface



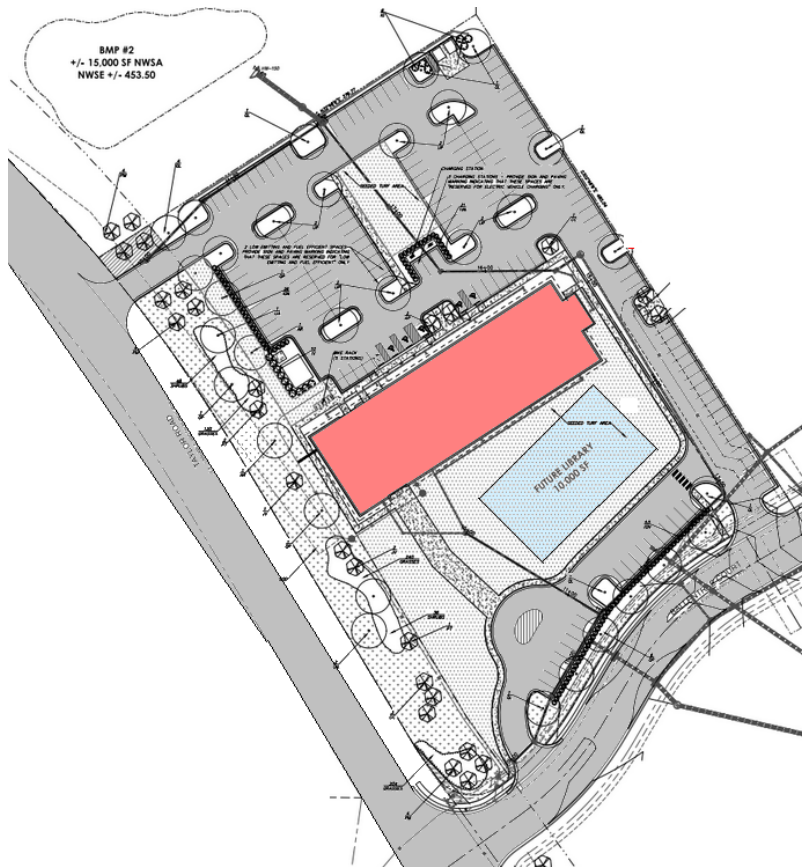

SITE PLAN



Programmed Spaces

Administration	3,000 sf
Common Areas	2,000 sf
Support Areas	6,000 sf
Classrooms	8,700 sf
Lab Areas	8,900 sf
<u>Common Areas / Misc.</u>	<u>11,400 sf</u>
Total Area	<u>±40,000 sf</u>

SPACE PROGRAMMING



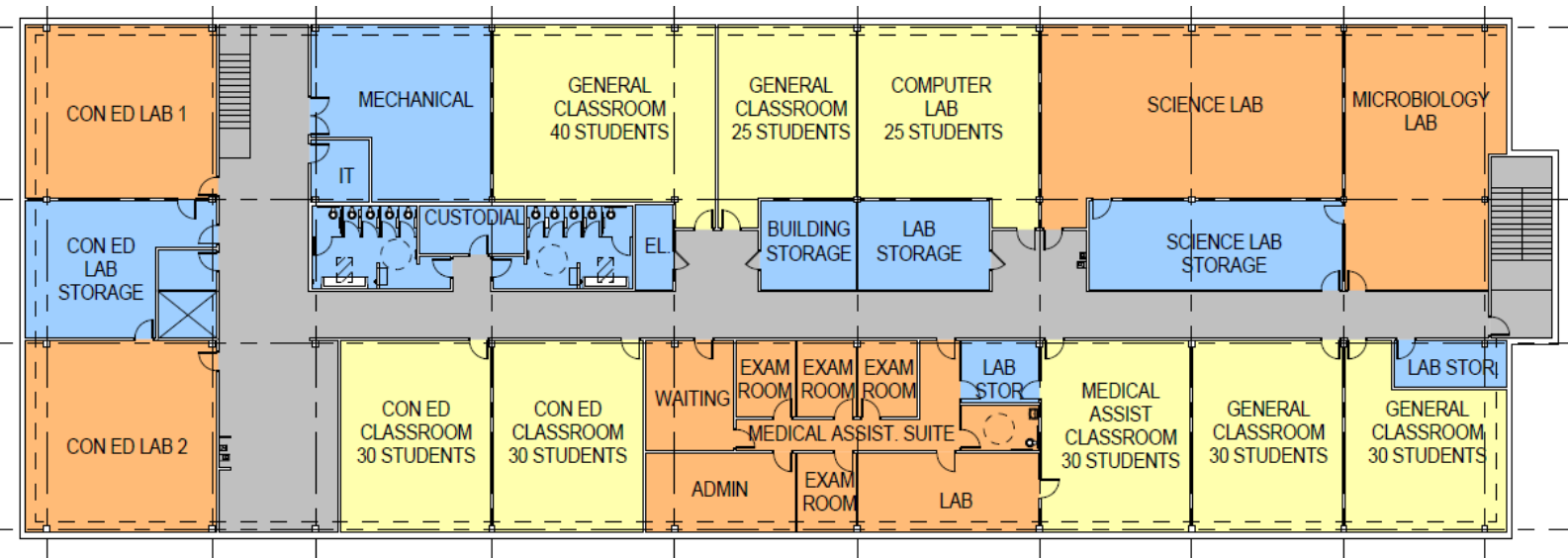

SECOND FLOOR PLAN

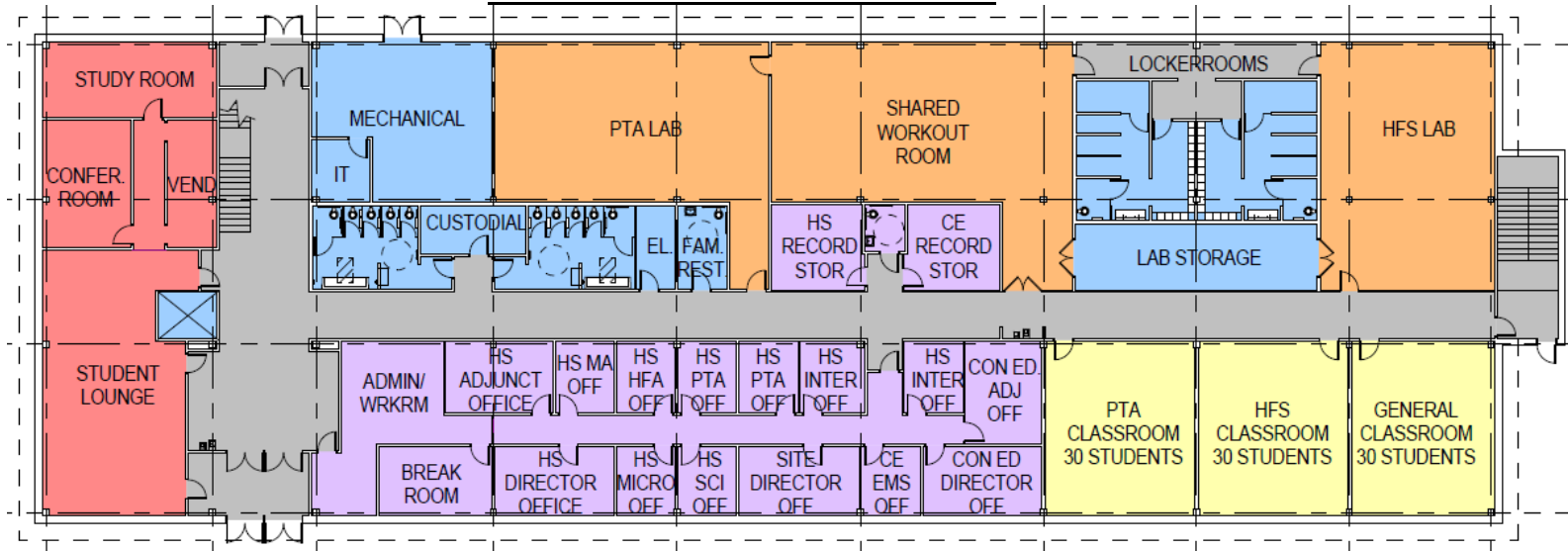

FIRST FLOOR PLAN

FLOOR PLANS



PERSPECTIVE VIEW





PERSPECTIVE VIEW



Schedule:

Out to Bid	April 2018
Open Bids	May 2018
Start Construction	July 2018
End Construction	July 2019

PROJECT SCHEDULE





New Health Sciences Building

Central Carolina Community College

Chatham County, North Carolina

January 2018

