

LEGEND

- INSTALL (RED)
- REMOVE (GREEN)
- EXISTING TO REMAIN (BLUE)
- ABANDON (ORANGE)
- TEMPORARY (YELLOW)
- PERMANENT UTILITIES EASEMENT (DASHED PINK)
- AERIAL UTILITIES EASEMENT (DASHED CYAN)

Safety Reminders / Adverse Conditions

WZS: Remember "Your Circle of Safety"

WZS: WZS: WZS:

USP: BREAKER: PC087
 USP: FEEDER: PITTSBORO 23KV
 USP: SUBSTATION: PITTSBORO 230KV
 USP: 30 ALL OUR CHILDREN LANE
 USP: MONCURE NC

REMEMBER: Work zone area conditions may have changed for this job! Everyone is responsible for verifying the above safety information is correct prior to any work being performed each day.

LAND AGENT & VEGETATION MANAGEMENT
 PROJECT#: DHR343004
 OPS CENTER: CH9D
 RESP. CENTER - ENG: I030 TREE CLEARING: E089 ROW: R655
 ACTIVITY - ENG: E TREE CLEARING: I ROW: E

DUKE ENERGY PROGRESS	PIKE ENGINEERING
Funding #: 29715057	Design By: Josiah Shackleton
Work Order #: 29715057	Design Completed: 08-13-15
Project #: DHR343004	Scale: 1" = 20'
Pittsboro Pedestrian Improvements Intersection of US 64 & US 15/501 Pittsboro, NC 27312 Chatham County	Office Phone: Cell Phone: 919-917-5015 Sheet #: UO-5

ALL TFOs ON THIS SHEET ARE IN A HFZ

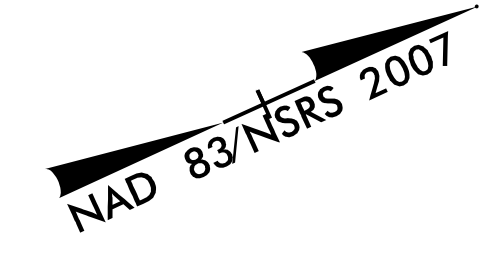
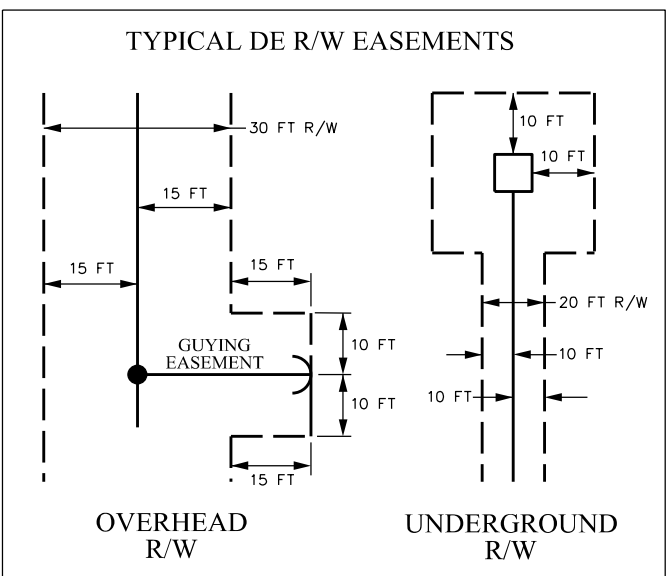

PIKE ENGINEERING
 2033 CORPORATE DR., SUITE A
 WILMINGTON, NC 28405
 LICENSURE #: 8687

PRELIMINARY DRAWING NOT FOR CONSTRUCTION

ALL CONSTRUCTION PER DUKE ENERGY PROGRESS SPECIFICATIONS, CODES AND MANUALS.

PRELIMINARY DUKE ENERGY PROGRESS DESIGN BASED ON 25% PLANS. THIS PRELIMINARY DESIGN IS SUBJECT TO CHANGE BASED ON RIGHT-OF-WAY ACQUISITION, SCOPE CHANGES, FINAL PLAN CHANGES, COORDINATION WITH OTHER UTILITIES, ETC.

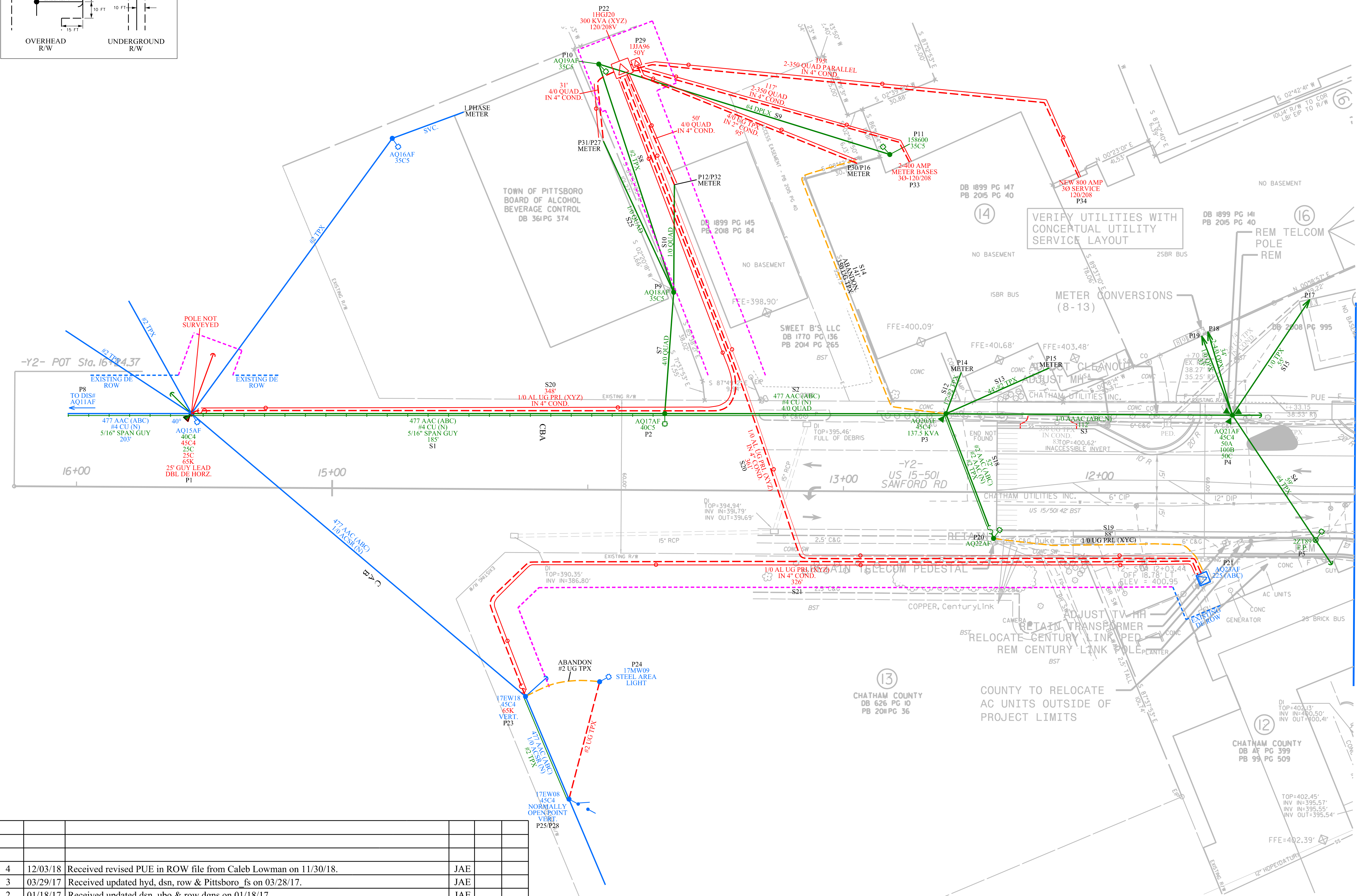

NO.	DATE	REVISION	BY	CK	APP
4	12/03/18	Received revised PUE in ROW file from Caleb Lowman on 11/30/18.	JAE		
3	03/29/17	Received updated hyd, dsn, row & Pittsboro fs on 03/28/17.	JAE		
2	01/18/17	Received updated dsn, ubo & row dgs on 01/18/17.	JAE		
1	12/29/16	Received updated curb, dsn & profile dgs on 12/20/16.	JAE		