

**PRELIMINARY MAP**  
EXHIBITION AND REVIEW PURPOSES ONLY

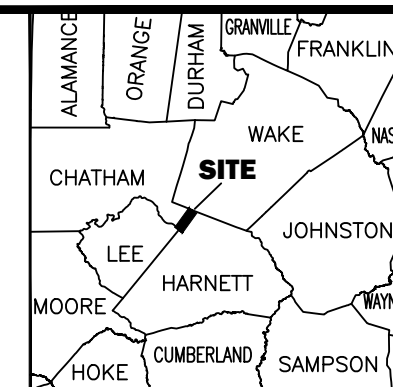

VICINITY MAP - NOT TO SCALE

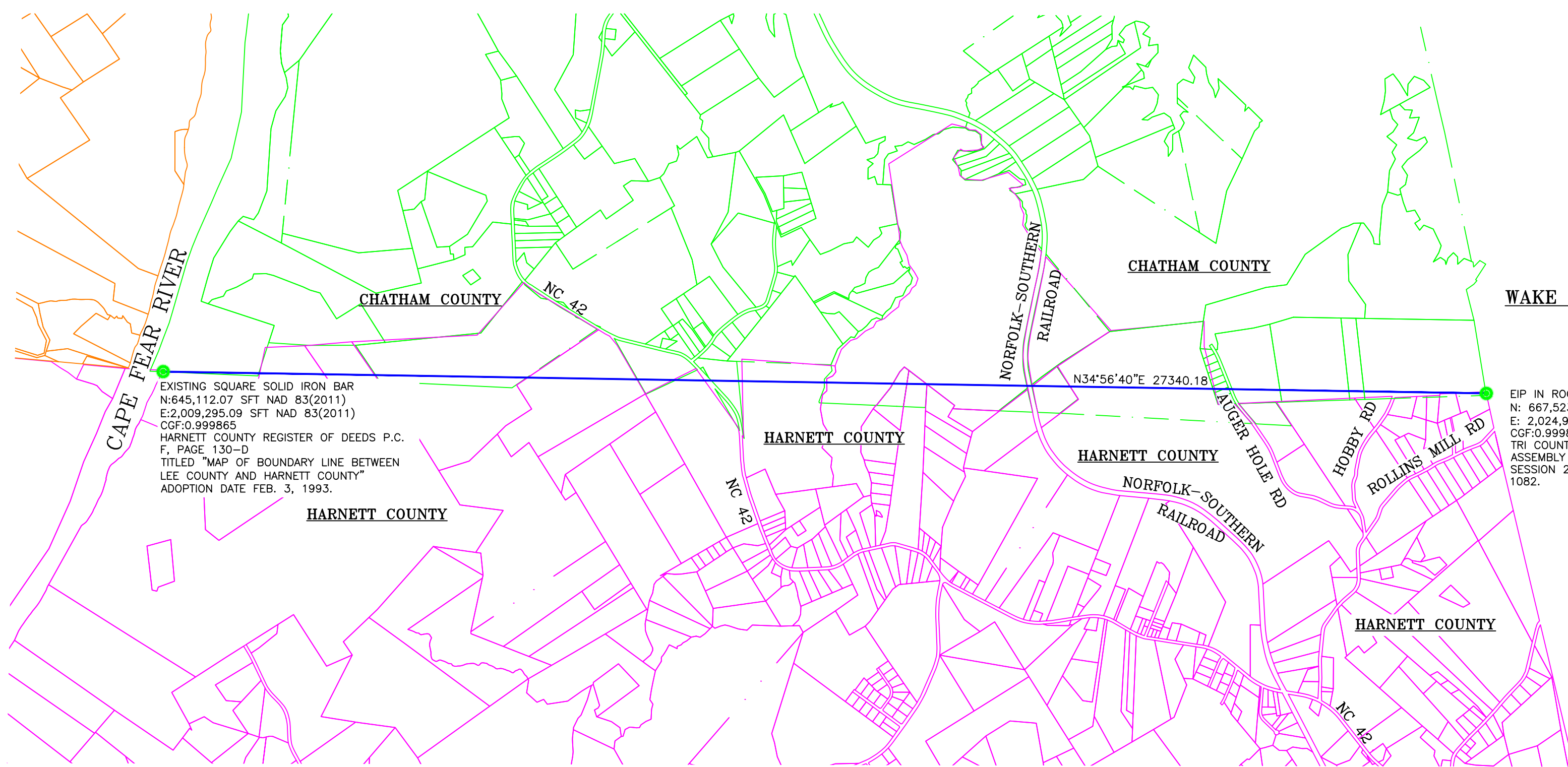
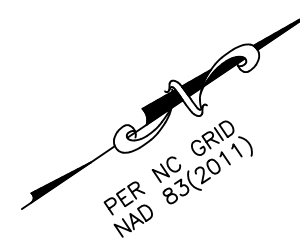

EXISTING SQUARE SOLID IRON BAR  
N:645,112.07 SFT NAD 83(2011)  
E:2,009,295.09 SFT NAD 83(2011)  
CGF:0.999865  
HARNETT COUNTY REGISTER OF DEEDS P.C.  
F, PAGE 130-D  
TITLED "MAP OF BOUNDARY LINE BETWEEN  
LEE COUNTY AND HARNETT COUNTY"  
ADOPTION DATE FEB. 3, 1993.

EIP IN ROCK PILE  
N: 667,523.04 sft NAD 83(2011)  
E: 2,024,955.02 sft NAD 83(2011)  
CGF:0.99985786  
TRI COUNTY CORNER PER GENERAL  
ASSEMBLY OF NORTH CAROLINA  
SESSION 2017-2018 HOUSE BILL  
1082.

**LEGEND**

- PROPOSED REESTABLISHED COUNTY LINE
- - - CHATHAM COUNTY GIS PARCELS
- - - HARNETT COUNTY GIS PARCELS
- - - LEE COUNTY GIS PARCELS
- EIP EXISITING IRON PIPE
- E EASTING
- N NORTHING
- NAD 83 NORTH AMERICAN DATUM 1983
- sft U.S. SURVEY FOOT

**PRELIMINARY MAP**  
EXHIBITION AND REVIEW PURPOSES ONLY

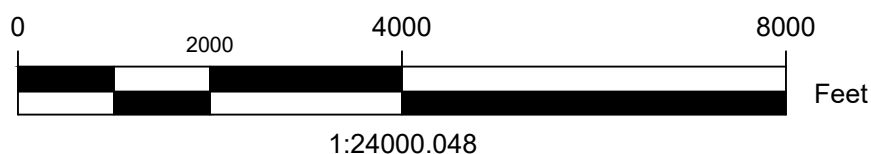

NORTH CAROLINA GEODETIC SURVEY  
Department of Public Safety  
Division of Emergency Management

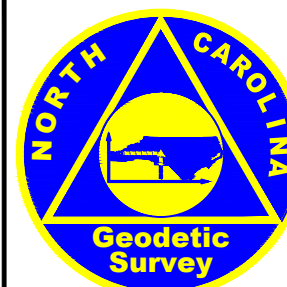

CLAUDE BOWERS BUILDING, 4105 REEDY CREEK ROAD  
RALEIGH, NORTH CAROLINA 27607 (919) 733-3836

PRELIMINARY PLAT OF RESURVEY

**CHATHAM COUNTY AND  
HARNETT COUNTY LINE**

STATE OF NORTH CAROLINA

DRAWN BY: DJF	CHECK BY: RRH
DATE: 10/4/2018	REV DATE: SCALE: 1"=2,000'

SHEET 1 OF 1